



## NANAO RESORT

The master plan is carved around a man-made lake as a figural environmental etching of an Atayal aborigine tattoo on the vast land. The buildings, of traditional aboriginal stone construction, perch on the water's edge like sculptural rock formations. The main building traces the hilly topography with its sinewy, undulating form to become the eastern contours of the lake. The Water Villa is designed as an entire island, with spaces sculpted from within the landmass and overhanging stone eaves that grow into the island's edge. The Eco-pod, scattered throughout the indigenous eucalyptus forest, is a unique camping structure with an upward spiraling plan that pivots around a central fireplace.

01 Bird's-eye view 02 View of lake 03 Site plan 04 Night view of eco pods in the eucalyptus forest

01

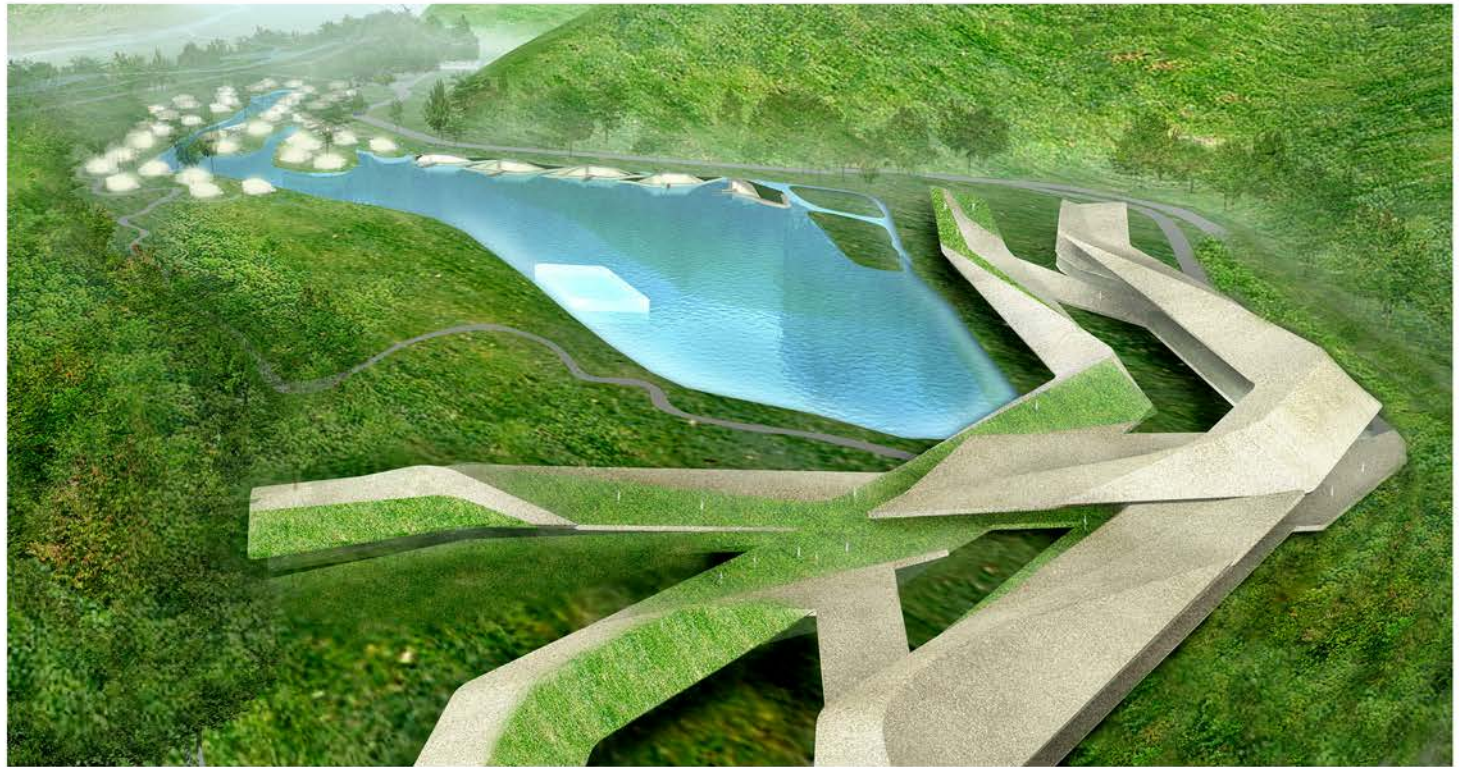

02

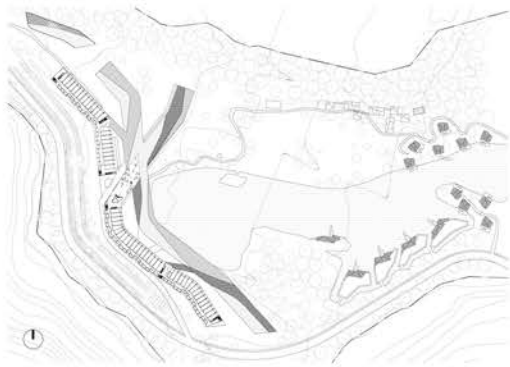

03



04